

## NOTES:

1. REFER TO SPECIAL CONDITION SPEC. SUPPLEMENTS G-01-18 OR G-08-19: UTILIZE FOAM OR OTHER METHOD TO PREVENT INFILTRATION OF INDOOR AIR INTO ROOF SYSTEM.
2. CONTRACTOR TO CUT SAT STRIPS IN THE FIELD.

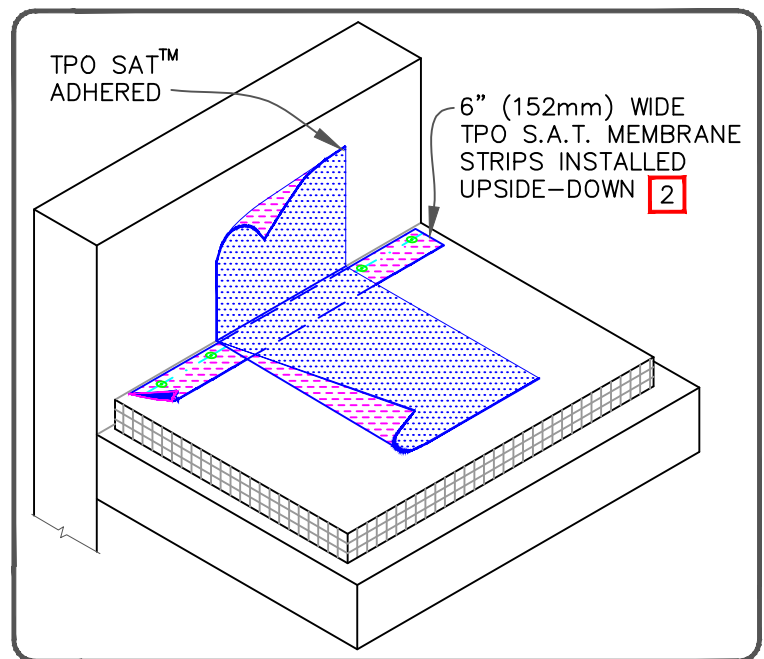

	<p>TPO SAT PARAPET FLASHING WITH TPO SAT RUSS SAT™ (SELF ADHERING TECHNOLOGY)</p> <p>For additional information, refer to Specifications</p>	<p>DETAIL NO. U-12H</p> <p>THERMOPLASTIC TPO</p>
---	--	--